

Transfer or duplication of this document as well as the utilization or communication of its contents are prohibited unless explicit authorization is granted. Violations will be liable for compensation. All rights reserved for patent, utility model or designs registrations. 禁止给予明确授权, 否则禁止转让、复制、利用、交流本文件的内容, 侵犯者将承担赔偿责任, 本公司保留对涉及发明、实用新型和外观设计的所有权利。

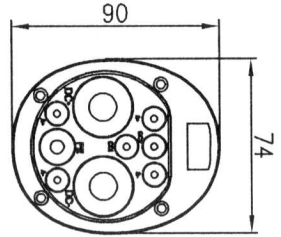

插针排布图

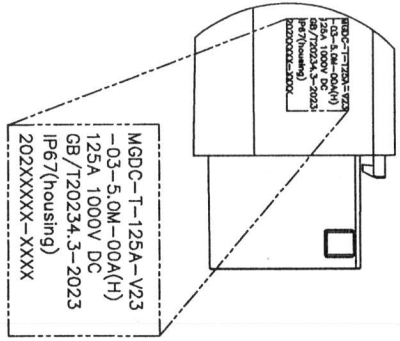
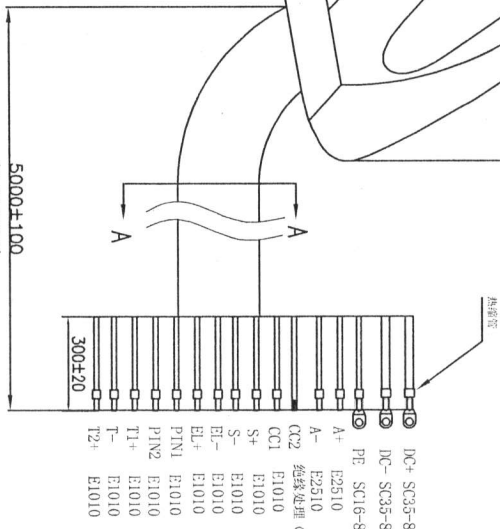
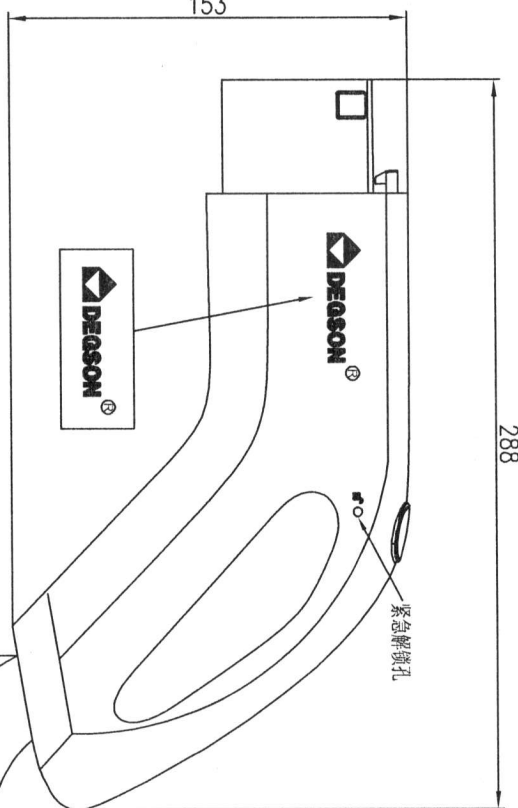

接线图

DC+	DC-	PE	A+	A-	C2	C1	S+	S-	EL+	EL-	PIN1	PIN2	T+	T-
蓝色(3.5mm ²)	蓝色(3.5mm ²)	黄绿色(1.6mm ²)	白色(2.5mm ²)	白色(2.5mm ²)	棕色(0.75mm ²)	棕色(0.75mm ²)	棕色(0.75mm ²)	棕色(0.75mm ²)	棕色(0.75mm ²)	棕色(0.75mm ²)	白色(0.75mm ²)	白色(0.75mm ²)	棕色(0.75mm ²)	棕色(0.75mm ²)



SEC A-A

TPU 黑色

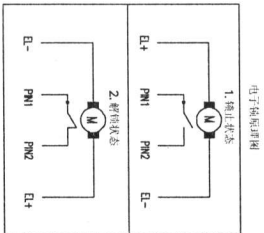

电子锁原理图

电子锁控制原理图:
 为电子锁提供正向12V电源控制电路;
 稳定电压 DC 12V (保持);
 最大电流 DC 12V±10%;
 最大电压 250mA;
 最大时间: 15100ms;
 最大导线长度: 3S (不允许长导线导通)
 1. 当锁芯正向12V电源时, 电子锁的锁杆上锁, 驱动开关的接触信号导通;
 2. 当锁芯正向12V电源时, 电子锁的锁杆解锁, 驱动开关的接触信号导通;
 3. 如果发生异常, 锁芯无法自动解锁, 请手动解锁。



Notes: R2=RG 1.5% R4=RG 1.5%

REV	EON	DESCRIPTION	DRFT	DATE	DRAWING NO.	TYPE	DRAWING STATUS	SCALE	SHEET
						CUSTOMER DRAWING		1:6	1/1

DEGSON

APPRO: [Signature] 2025.7.18
 CHKD: [Signature] 2025.8.1
 DRT: [Signature] 2025.8.18

MATERIAL: / DO-1 MAT STATUS: /
 SURFACE/COLOR: /

MGDC-T-125A-V23-03-5.0M-00A(H)

额定电压/电流/Rated voltage/Current	1000V DC 125A
绝缘电阻/Insulate resistance	>500MΩ/500V DC 1min
耐压/Withstanding voltage	DC+DC- and PE 3500V AC 1min
耐久等级/Ingress protection	DC+ and DC- 3500V AC 1min
使用寿命/Insertion/Pullout times	10,000 Times
插拔力/Insertion/Pullout force	IP67(housing) <140N
使用温度范围/Operating temperature(°C)	-30~+50
线材规格/Cable specification	2*35+1*16+2*2.5+(4*0.75)(P2)+7*0.75
标准/Reference standard	GB/T 20234.3-2023
符合RoHS环保要求/Conform to RoHS	Yes