

Transfer or duplication of this document as well as the utilization or communication of its contents are prohibited unless explicit authorization is granted. Violations will be liable for compensation. All rights reserved for patent, utility model or designs registrations. 除非经许可明确授权，否则禁止转让、复制、利用、交流本文件的内容。侵犯者将承担赔偿责任。本公司保留对涉及发明、实用新型和外观设计的所有权利。

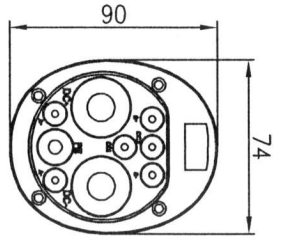

插针排布图

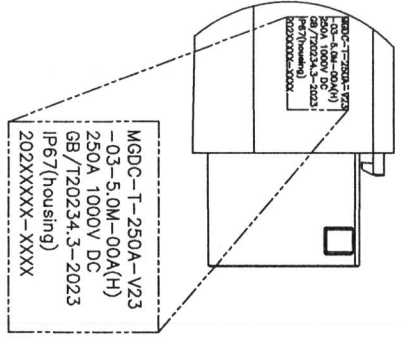
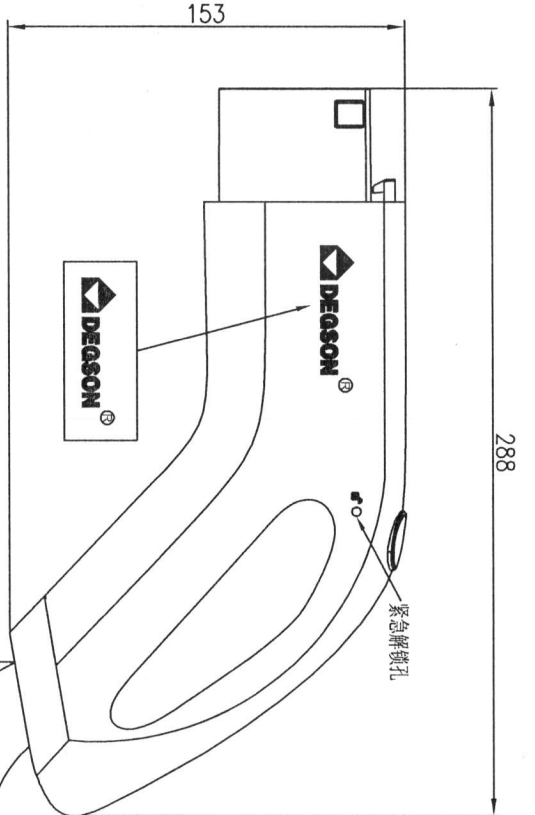

紧急解锁孔

热缩管

DC+	DC-	PE	A+	A-	CC2	CC1	S+	S-	EL+	EL-	PN1	PN2	T1+	T1-	T2+
DC+ SC95-8	DC- SC95-8	PE SC16-8	A+ E2510	A- E2510	CC2 绝缘处理 (包热缩管)	CC1 E1010	S+ E1010	S- E1010	EL+ E1010	EL- E1010	PN1 E1010	PN2 E1010	T1+ E1010	T1- E1010	T2+ E1010

(拉直后测量)

接线图

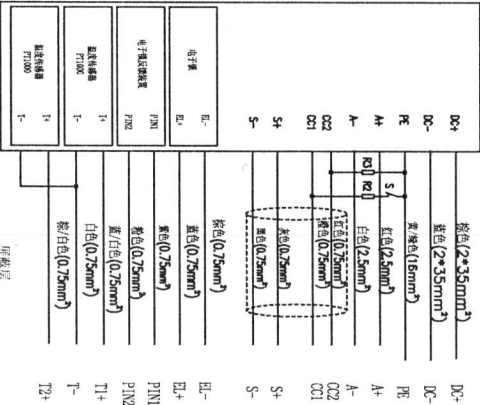

Notes: PE-180±.38; PE-180±.38



DC+	棕色(2*35mm ²)
DC-	蓝色(2*35mm ²)
PE	黄绿色(16mm ²)
A+	红色(2.5mm ²)
A-	蓝色(2.5mm ²)
CC2	白色(0.75mm ²)
CC1	白色(0.75mm ²)
S+	棕色(0.75mm ²)
S-	蓝色(0.75mm ²)
EL+	棕色(0.75mm ²)
EL-	蓝色(0.75mm ²)
PN1	白色(0.75mm ²)
PN2	白色(0.75mm ²)
T1+	棕色(0.75mm ²)
T1-	蓝色(0.75mm ²)
T2+	棕色(0.75mm ²)

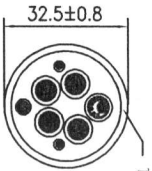

SEC A-A

TPU 黑色

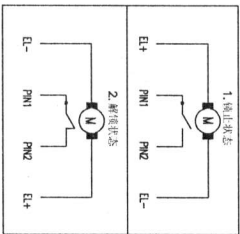

电子锁接线图

- 电子锁控制原理:
1. 当提供正向12V电源时, 电子锁的锁芯上锁, 驱动开关的接触信号断开;
 2. 当提供反向12V电源时, 电子锁的锁芯解锁, 驱动开关的接触信号导通;
 3. 如发生异常, 客户无法自行解锁, 请手动解锁。



MATERIAL: / DO-1

SURFACE/COLOR: MMT STATUS:

额定电压/Rated voltage/Current	1000V DC 250A
绝缘电阻/Insulate resistance	>500MΩ, 500V DC 1min
耐压/Withstanding voltage	DC+、DC- and PE 3500V AC 1min
防护等级/Ingress protection	IP67(housing)
插拔次数/Insertion/Pullout times	10,000 Times
插拔力/Insertion/Pullout force	<140N
使用温度范围/Operating temperature(°C)	-30~+50
线材规格/Cable specification	4*35+16+2*2.5+(2*0.75)/(P2)+7*0.75
标准/Reference standard	GB/T 20234.3-2023
符合RoHS/符合RoHS要求/Conform to RoHS	Yes

REV	ECN	DESCRIPTION	DRT	DATE

DRPT	DATE	DRPT	DATE

DRPT	DATE	DRPT	DATE

TYPE	DRAWING NO	DRAWING STATUS	SCALE	SHEET
CUSTOMER DRAWING	MGDC-T-250A-V23-03-5.0M-00A(H)		1:6	1/1