

Transfer or duplication of this document as well as the utilization or communication of its contents are prohibited unless explicit authorization is granted. Violations will be liable for compensation. All rights reserved for patent, utility model or designs registrations. 除特别声明外, 未经许可, 不得复制或传播本文件内容, 否则, 公司将依法追究法律责任。 保留所有权利, 侵权必究。

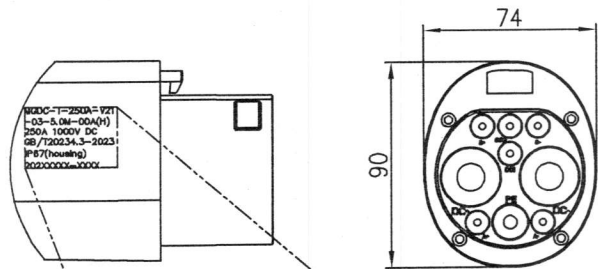

插针排布图

MGDC-T-250A-V21  
-03-5.0M-00A(H)  
250A 1000V DC  
GB/T20234.3-2023  
IP67(housing)  
202XXXXX-XXXX

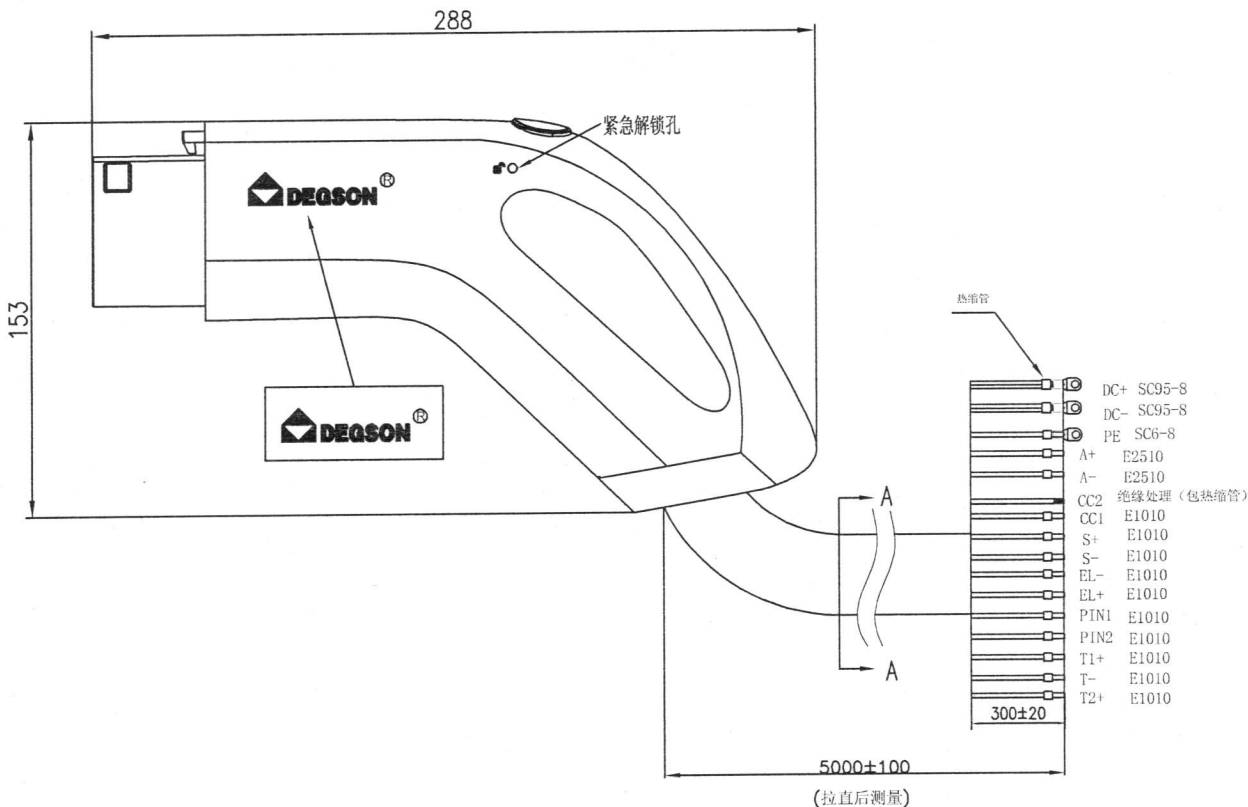

接线图

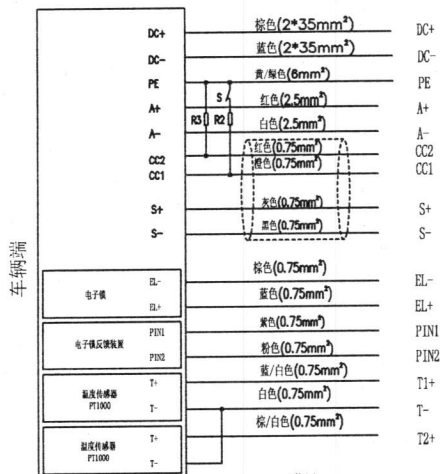

Notes: R2-1KΩ±3% R3-1KΩ±3%

所截左:

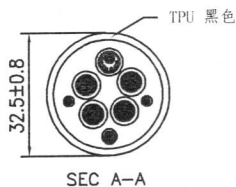

电子锁控制原理:  
为电子锁提供正向12V和反向12V电源控制电路;  
额定电压: DC 12V (脉冲);  
电压范围: DC 12V±10%;  
最大电流: 250mA;  
触发时间: T≤100ms;  
最大导通时间: 3S (不允许长时间导通)  
1.当提供正向12V电源时, 电子锁的顶杆上锁, 微动开关的检测信号导通;  
2.当提供反向12V电源时, 电子锁的顶杆解锁, 微动开关的检测信号导通;  
3.如果发生异常, 帐户无法自动解锁, 请手动解锁。

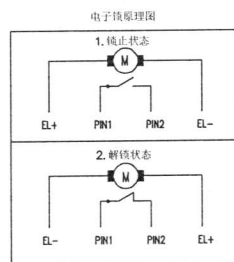

额定电压/电流/Rated voltage/Current	1000V DC 250A
绝缘电阻/Insulate resistance	>500MΩ, 500V DC 1min
耐压/Withstanding voltage	DC+, DC- and PE 3500V AC 1min
防护等级/Ingress protection	IP67(housing)
插拔寿命/Insertion/Pullout times	10,000 Times
插拔力/Insertion/Pullout force	<140N
使用温度范围/Operating temperature(°C)	-30~+50
线材规格/Cable specification	4*35+6+2*2.5+(2*0.75)(P2)+7*0.75
标准/Reference standard	GB/T 20234.3-2023
符合RoHS环保要求/Conform to RoHS	Yes

		MATERIAL:	SURFACE/COLOR:	
APPD: <i>Kevin 2025.9.14</i>		MAT NO./REV:	/ DO-1 MAT STATUS:	
CHKD: <i>Beck 2025.7.8</i>		NAME: MGDC-T-250A-V21-03-5.0M-00A(H)		
DRFT: <i>PPS 2025.9.14</i>		DRAWING NO.	TYPE	DRAWING STATUS
		CUSTOMER DRAWING		SCALE: 1:6
REV		ECN	DESCRIPTION	DRFT
DATE		SHEET		1/1